

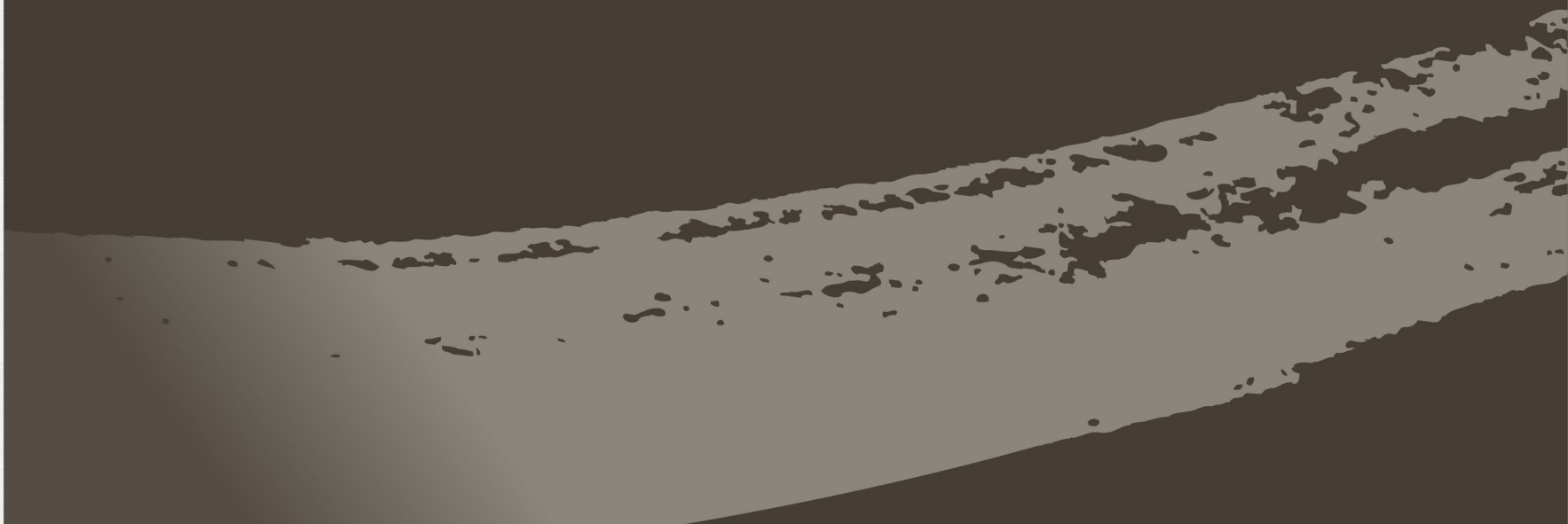

Grizalland AT MAGERSARI
Start now life better



LOCATION

APPROXIMATELY

- 1 KM - SUNRISE MALL
- 1 KM - AYOLA HOTEL
- 0,5 KM - MCD
- 0,5 KM - SMKN I KOTA
- 0,5 KM - BENTENG PANCASILA

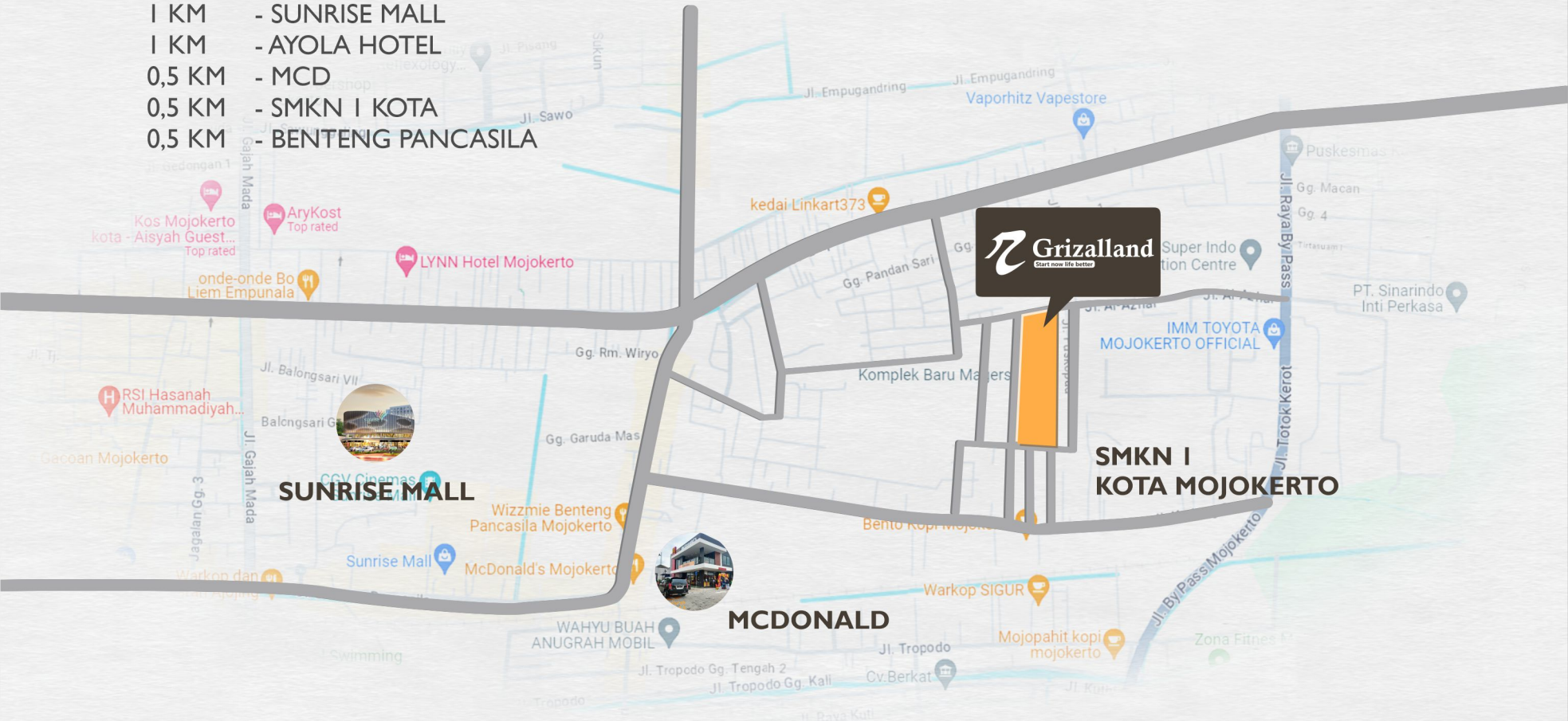

DEVELOPER :



MARKETING OFFICE

Taman Anggun Sejahtera 6 Blok A8 No 35
PT Grizalland Inti Sinaragung

0812 8883 6665 | www.grizalland.com



- 1 MAIN GATE
- 2 ENCHANTING GARDEN
- 3 EXO EXPLORE GARDEN (BOARDWALK)
- 4 SECONDARY ENTRANCE

Pondasi	: Beton Bertulang
Struktur Bangunan	: Beton Bertulang
Dinding	: Bata Merah
Lantai	: Granit 60x60
Atap	: Rangka Galvalum, Genteng Beton
Plafond	: Gypsum
Kusen, Pintu, Jendela	: Kayu & Aluminium
Sanitair	: Standard
Air Bersih	: Sumur Bor
Listrik	: 1300 Watt

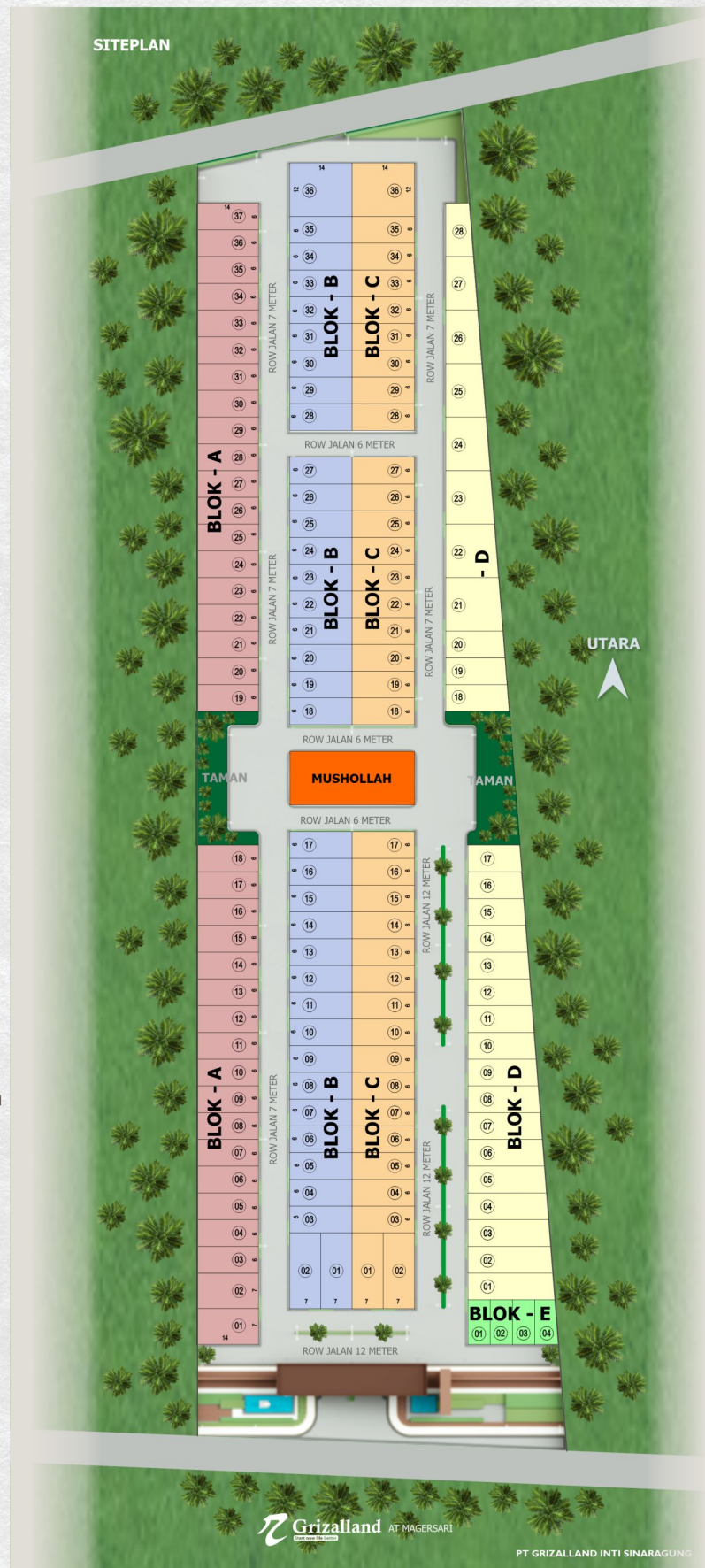



Type A (6X14) BLOK A & B
luas tanah 84 M2 | Luas Bangunan 45M2

Bedrooms 2 Bathrooms | Kitchen | Carport



Type B (6X14) BLOK C & D
luas tanah 84 M2 | Luas Bangunan 45M2

Bedrooms 2 Bathrooms | Kitchen | Carport

Denah
Type A
(6X14)



Denah
Type B
(6X14)

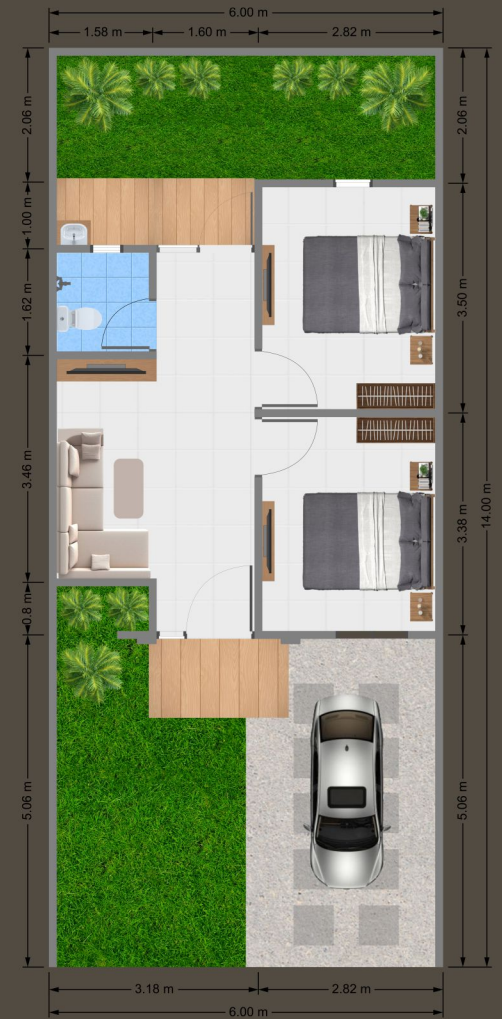

 **Grizalland** AT MAGERSARI
Start now life better

2.2 Ha

Cluster Area

For premium types where coming home is a holiday, every day.

24 hrs

Security

Sleep soundly in this gated neighborhood with 24 hour manned security





WELCOME HOME

 **Grizalland** AT MAGERSARI
Start now life better

A limited opportunity to own a landed home in a community surrounded by comprehensive family-friendly facilities and greenery in a private river front community.

